

NOTICES:

- Use a professional/licensed electrician and follow all local/applicable safety regulations.
- Inspect the entire light unit before beginning installation.
- Make certain power is OFF before installing or maintaining fixture. No user serviceable parts inside.
- To prevent wiring damage or abrasion, do not expose wiring to edges of sharp objects.

CAUTION:

- For proper vapor/moisture function all gaskets must be seated properly and all screws inserted and tightened firmly. Make sure nothing obstructs the gasket area, or dirt/residue/materials comes in contact with the gasket. Also a broken or cracked lens will not be able to function as designed, so take care of the lens.

- 1) To access the inside, unlock the latches and remove the lens. Slide the Power Cable through the fixture hole and fitting. The VTL fixture can be end-to-end mounted with several other fixtures. If installed as one unit, a Cap End can be installed at the other end.

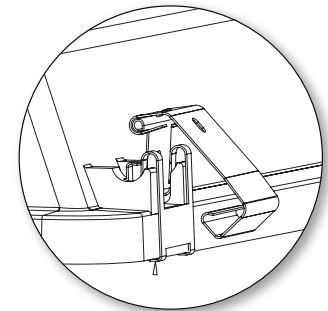

- 2) Wire unit to your power lead, and inspect to ensure that all connections are secure. Close the unit and make sure ALL the latches snap firmly into place and that the lens is securely held in place.
- 3) Install the unit(s) to the ceiling/wall and make sure they are level and flat.

Lighting unit/lens integrity is KEY to making sure your lights work as expected. Care should be taken in the handling/installation to make sure that a proper seal is achieved. Keep all surfaces clean, damage free, and tighten all hardware thoroughly.

SURFACE MOUNT (CEILING OR WALL):

1. Using the supplied brackets, mark location for mounting holes. For each bracket, drill a pilot hole. Insert wood screws through slots on mounting bracket. Tighten screws to secure bracket to mounting surface.

Repeat for other mounting bracket. Drill holes in mounting surface for mounting with plastic toggle nut and screw. Push plastic toggle nuts into pre-drilled holes. Insert screws through slots on mounting bracket. Push screw into holes until toggle nut expands.

Tighten screws to secure bracket. Repeat for other mounting bracket. Lift Fixture housing to mounting Brackets and snap in place. Fixture is now secure.

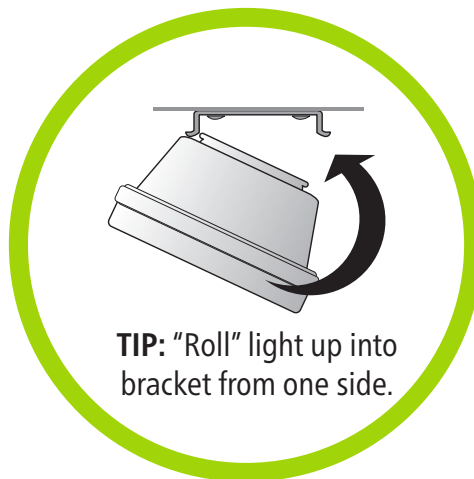
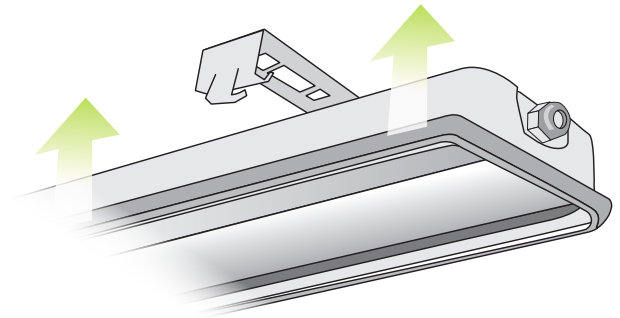
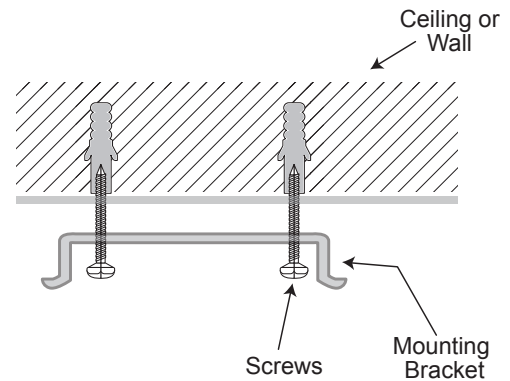

OFFSET SURFACE MOUNT (CEILING OR WALL):

1. Same installation procedure as with surface mount, but using an offset bracket.

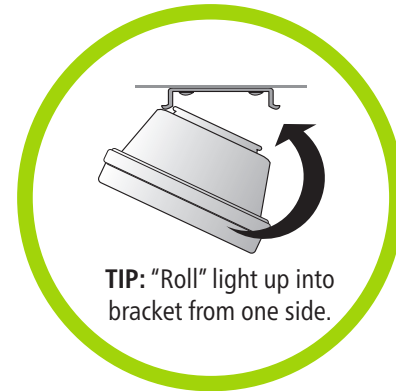
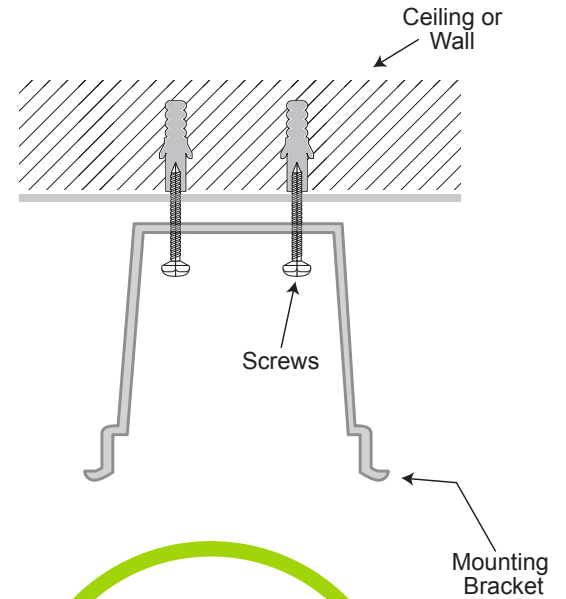
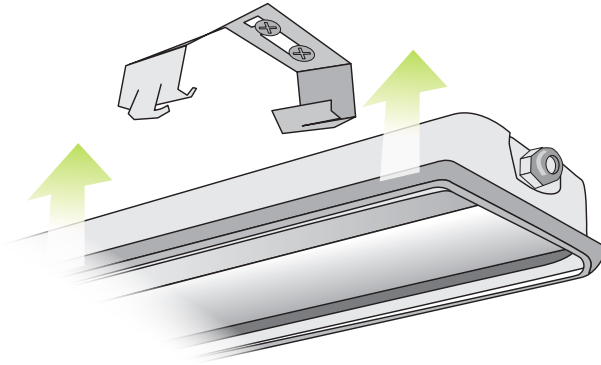

PENDANT MOUNT:

1. Flip bracket over and snap into place on light unit. Attach your pendant to the bracket. Repeat on other end.

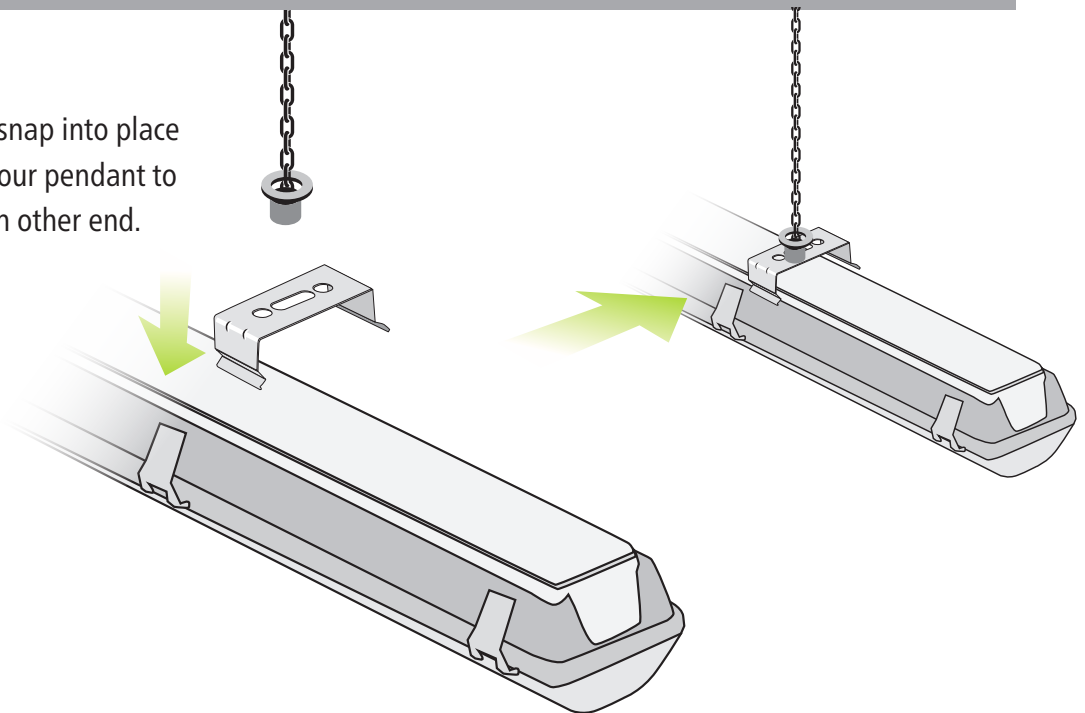

The following limited warranty policy applies only to the original purchaser of this product and is not transferable. Evidence of original purchase is required for warranty service. ADVANTAGE ENVIRONMENTAL LIGHTING will assume no liability for indirect, incidental, consequential damages of any kind or liquidated damages arising out of a breach of the sale. Any assistance ADVANTAGE ENVIRONMENTAL LIGHTING provides outside of the terms and exclusions of these warranties will not constitute a waiver of the warranty terms and exclusions, nor will such assistance revive or extend the warranty. The determination of whether the product is defective shall be made by ADVANTAGE ENVIRONMENTAL LIGHTING in its sole discretion with consideration given to the overall performance of the product.

ELEMENTS OF WARRANTY

Advantage Environmental Lighting warrants for the specified time period outlined below for each individual product category, to the original purchaser, this product to be free from defects in materials and workmanship under intended normal use, subject only to the limitations and exclusions set out below.

LED PRODUCT LIMITED WARRANTY

ADVANTAGE ENVIRONMENTAL LIGHTING warrants that the product, when delivered in new condition and in its original packaging, will be free of defects in material and workmanship for a period of FIVE (5) YEAR from the date of original purchase. A LED product shall not be considered defective solely as a result of the failure of an individual LED. The product will be considered defective only if a total of 15% or more of the individual LEDs in the product fail to illuminate.

EMERGENCY BATTERY LIMITED WARRANTY

ADVANTAGE ENVIRONMENTAL LIGHTING warrants that in products containing an emergency battery pack, when delivered in new condition and in its original packaging, the emergency battery pack will be free of defects in material and workmanship for a period of ONE (1) YEAR from the date of original purchase.

STATEMENT OF REMEDY

In the event the product does not conform to this warranty at any time while this warranty is in effect, ADVANTAGE ENVIRONMENTAL LIGHTING will repair or replace the product at ADVANTAGE ENVIRONMENTAL LIGHTING's sole discretion. The limited warranty set forth above is the sole and entire warranty pertaining to the product and is in lieu of and excludes all other warranties of any nature whatsoever, whether express, implied, or arising by operation of law, including, but not limited to any implied warranties of merchantability or fitness for a particular purpose. This warranty does not cover or provide for the reimbursement or payment of incidental or consequential damages.

PROCEDURE FOR WARRANTY CLAIMS

Before you return your product for a warranty claim, contact your ADVANTAGE ENVIRONMENTAL LIGHTING customer service representative for complete shipping instructions and to obtain a Return Authorization (RA) number. Any product returned for warranty repair must be delivered freight prepaid in either its original packaging or packaging affording an equal degree of protection.

THIS WARRANTY IS EFFECTIVE FOR PURCHASES OF PRODUCT ON OR AFTER THE EFFECTIVE DATE SET FORTH BELOW. ADVANTAGE ENVIRONMENTAL LIGHTING RESERVES THE RIGHT TO MODIFY THIS WARRANTY FROM TIME TO TIME WITHOUT NOTICE. ANY MODIFICATION OF THIS WARRANTY SHALL BE EFFECTIVE FOR ALL ORDERS PLACED ON OR AFTER THE EFFECTIVE DATE OF THE REVISED WARRANTY. EFFECTIVE DATE: JANUARY 1, 2023

IF YOU NEED SERVICE

Contact us with any questions concerning the warranty of an Advantage Environmental Lighting product.