

LRCWL

RECESSED LED
TROFFER
SUITABLE FOR WET
LOCATIONS



The **LRCWL** is a IP65, IC-rated luminaire which provides a cost effective LED clean room lighting solution. Gasketed housing and door frame create a sealed enclosure. The LRCWL is available in 1X4, 2x2 and 2x4 sizes. Available options such as anti-microbial paint, 90 CRI, and 14W emergency driver. Suitable for ISO 5 Cleanrooms. This fixture was designed for healthcare facilities, cleanrooms, and any insulated ceilings.

DOORFRAME: Inset door frame constructed of .063" aluminum (or choose from cold rolled steel options). White TGIC polyester powder coat standard, with optional anti-microbial white paint. Closed-cell gasket completely seals the doorframe and the housing.

ELECTRICAL SYSTEM: Electronic driver 0-10V 1% dimming standard. Long-life LED system rated for >100K hours (L70 @ 25°C). Complies with federal energy efficiency standards.

OPTICAL SYSTEM: A variety of lensing options are available to fit the needs of any application. If additional lensing options are needed, consult factory.

LISTINGS: Approved to CSA and ETL standards. Food Safe, NSF compliant design. IP65 rating. ISO 5 certified.

MOUNTING: Recessed grid mounting.

HOUSING: Available in 18 or 20 gauge cold roll steel, or .063" aluminum. If options needed are not listed, consult factory. Seam-welded construction. Closed cell gasket seals doorframe to housing. White TGIC polyester powder coat standard. Antimicrobial paint optional.

LED: 80 CRI or 90 CRI LEDs available in 2700K, 3000K, 3500K, 4000K and 5000K. Life is 100,000 hours at 70% lumen maintenance. LM79, LM80 and TM21 compliant.

WARRANTY: 5-Year Limited Warranty. Complete warranty and terms located at www.aelnow.com/warranty.

Ordering Information on Next Page ►

ORDERING INFORMATION:

Example: LRCWL-24-40-9L-B20-ALHINS-S-M-VDO

| SERIES | | SIZE | | CCT | | ILLUMINATION LEVEL | | HOUSING | | DOOR MATERIAL (INSET) | | | | |
|--------|--|------|-------|-----|------------------------------|--------------------|-----|--------------------------------|--|-----------------------|--------------------------|--------------------------|--|--|
| LRCWL | | 14 | 1X4 | 27 | 2700K | | 4L | 4000 Lumens (Standard Low) | | B20 | 20 Gauge Cold Roll Steel | | | |
| | | 22 | 2X2 | 30 | 3000K | | 7L | 7000 Lumens (Medium Low) | | ALH | .063 Aluminum | | | |
| | | 24 | 2X4 | 35 | 3500K | | 11L | 11000 Lumens (High Low) | | | B18 | 18 Gauge Cold Roll Steel | | |
| | | | | 40 | 4000K | | 12L | 12000 Lumens (Standard Medium) | | | | | | |
| | | 50 | 5000K | 13L | 13000 Lumens (Medium Medium) | | 15L | 15000 Lumens (High Medium) | | | | | | |
| | | | | 16L | 16000 Lumens (Standard High) | | 20L | 20000 Lumens (Medium High) | | | | | | |
| | | | | 20L | 20000 Lumens (Medium High) | | 25L | 25000 Lumens (High High) | | | | | | |
| | | | | | | | XX | Custom Lumens | | | | | | |

| LENS | | VOLTAGE | | CIRCUITS | | DRIVER OPTIONS | | OPTIONS | |
|-------|-------------------------------------|---------|-------------------------|----------|------------|----------------|---|---------|---|
| PA125 | .125 Inverted Prismatic Acrylic | M | Multi-Volt (120-277VAC) | 1 | 1 Circuit | BLANK | 0-10V 1% Dimming Driver (included standard) | 14EBL | 14 Watt Emergency Driver |
| S | Satin Lens | | | 2 | 2 Circuits | CD5 | 0-10V 5% to Off Dimming Driver | 90 | 90 CRI |
| 125P | Clear .125 Polycarbonate Outer Lens | | | | | EDN | Electronic Driver Non-Dimming | AM | Anti-Microbial White Paint |
| | | | | | | DALI | 1% Dali Dimming Driver | VDO | Lutron Vive Integral Fixture Control (RF with Daylight and Occupancy Sensing) |
| | | | | | | LEDE1 | Lutron Hi-lume 1% EcoSystem LED driver with Soft-on, Fade-to-Black dimming technology | | |

Dimensions on Next Page ►

ENERGY AND PERFORMANCE DATA

| | |
|---------------------------|-------------------------------|
| INPUT VOLTAGE: | 120/277VAC |
| SYSTEM INPUT POWER: | 25.0 - 156.3 WATTS* |
| DELIVERED LUMEN OUTPUT: | 4000 - 25000 LUMENS |
| STANDARD DIMMING CONTROL: | 0-10V |
| CCT: | 3000, 3500, 4000, 5000 KELVIN |
| CRI: | 80 (MINIMUM) |
| LIFE TIME RATING: | >100,000 HRS @ L70 |
| INPUT FREQUENCY: | 50/60 HZ |
| POWER FACTOR: | >0.9 |
| OPERATING TEMP: | -30° TO 50° C |

APPROXIMATE COLOR TEMPERATURE MULTIPLIER

| | | |
|-------|---|------|
| 5000K | X | 1.03 |
| 4000K | X | 1 |
| 3500K | X | .97 |
| 3000K | X | .94 |
| 2700K | X | .91 |

| OUTPUT | DELIVERED LUMENS | WATTS | L70 @20C (HRS) |
|--------|------------------|-------|----------------|
| 4L | 4000 LUMENS | 25.0 | >100K |
| 7L | 7000 LUMENS | 43.8 | >100K |
| 11L | 11000 LUMENS | 68.8 | >100K |
| 12L | 12000 LUMENS | 75.0 | >100K |
| 13L | 13000 LUMENS | 81.3 | >100K |
| 15L | 15000 LUMENS | 93.8 | >100K |
| 16L | 16000 LUMENS | 100.0 | >100K |
| 20L | 20000 LUMENS | 125.0 | >100K |
| 25L | 25000 LUMENS | 156.3 | >100K |

*ACTUAL WATTAGE MAY DIFFER BY ±5% WHILE OPERATING 120/277V ±10%

DIMENSIONS

PROFILE

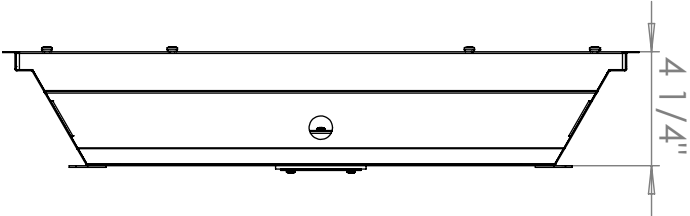

1X4

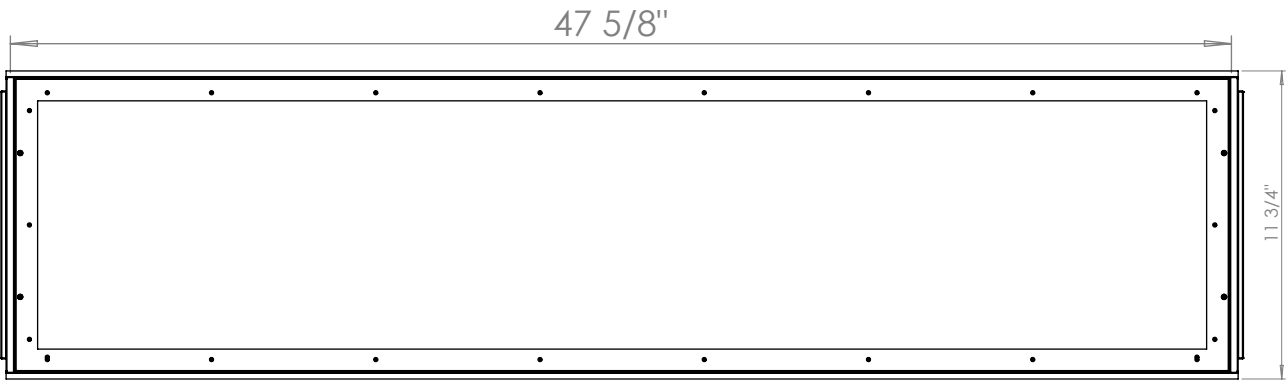

2X2

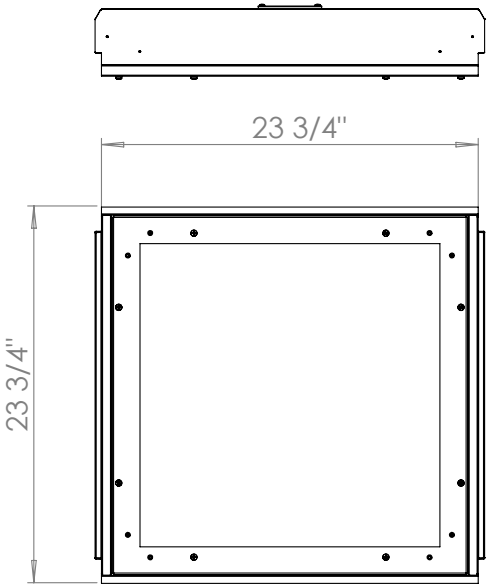

2X4

