

LDL24SMSWL

2.5"x4.5" LED Surface Mount Steel Wet Location Luminaire

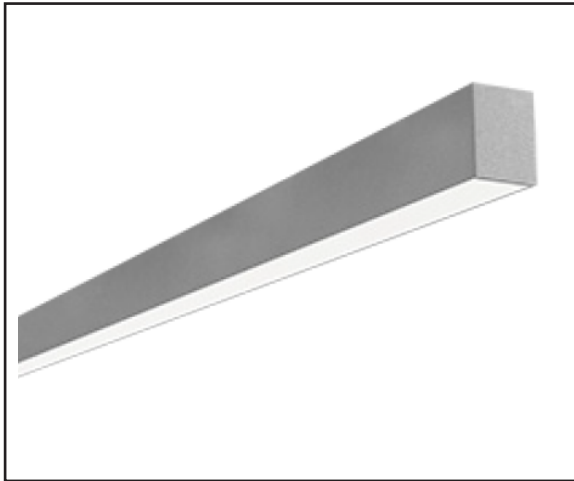

STANDARD

OPTIONAL



ORDERING INFORMATION

Example: LDL24MSW35MSMW4

Options: 12EBL

PRODUCT SPECIFICATIONS

DESCRIPTION

The LDL24SMSWL is an architectural luminaire designed for wet, surface mounted locations. It is available for continuous run mounting. Driven by performance and a clean aesthetic, the LDL24SMSWL series represents the ultimate in simplicity; a narrow, uniform line of light. Constructed with premium materials with industry leading technology, the 24 Series is available in configurable runs. The LDL24SMSWL integrates seamlessly with today's modern building management systems. With virtually unlimited applications, the 24 Series allows architects and designers the freedom to experiment with their designs without exceeding ever decreasing energy budgets.

APPLICATIONS

The LDL24SMSWL Series is designed to be a high quality, energy efficient LED fixtures for use in hotel lobbies, offices, common areas, hospitals, museums, retail, schools, wet area and professional business environments.

CONSTRUCTION

The fixture is constructed of a 2.5" wide heavy gauge steel body. The fixture is available in any run length within 1' increments. Heavy duty housing crimped along sides for extra rigidity and straight alignment.

OPTICAL SYSTEM

High output LED's available in 3000K, 3500K, 4000K, and 5000K. CRI >82. Satin lens provides for a beautiful architectural design while maintaining optimal light output.

ELECTRICAL SYSTEM

Electronic drivers are available for 120/277V applications. Long-life LED system rated for >50K life hours (L70 @ 25°C). Metal gear tray for internal LED driver. Complies with federal energy efficiency standards.

ACI BH-B;

The fixture can be surface mounted, recess mounted in either a standard grid ceiling, or it may be ordered with a flange kit or mud flange kit to allow for mounting into sheet rock. Continuous run available.

@GH-B; G

Independently tested to IESNA LM-79 and LM-80 specifications. UL and cUL Listed.

K 5 F F 5 BHM

5-Year Limited Warranty. Complete warranty & terms located at www.aelnow.com/resources.

SERIES	COLOR TEMP		OUTPUT		LENS	
LDL24SMSWL	30	3000K	S	Standard	S	Satin
	35	3500K	HS	High Standard		
	40	4000K	M	Medium		
	50	5000K	HM	High Medium		

VOLTAGE		FINISH		ROW LENGTH		OPTIONS	
M	120/277 (Multi-Volt)	W	White	2	2 Feet	12EBL	1200 Lumen Emergency Ballast
			Special	3	3 Feet	FW	Flex Whip Cable 6'
		SP		4	4 Feet		
				5	5 Feet		
				6	6 Feet		
				7	7 Feet		
				8	8 Feet		
				XX	XX Feet		

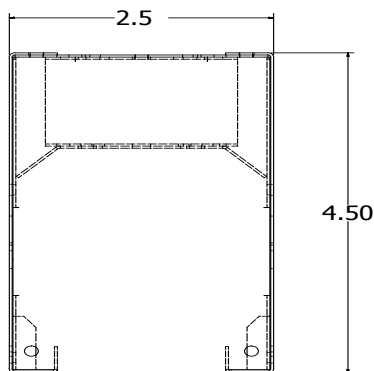
FIXTURE DIMENSIONS

ROW CONFIGURATIONS

AEL would like to double check your Bill of Material upon placement of your order if the number of rows and their individual row lengths are provided on the purchase order as follows:

Row 1 - 8'

Row 2 - 8'

Row 3 - 24'

Row 4 - 24'

Please provide any additional pertinent information such as additional power drops required mid-row.

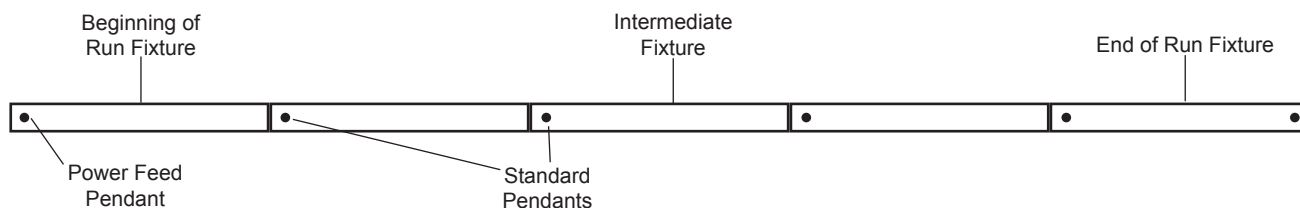

Row Length	2'	4'	6'	8'	10'	12'	14'	16'	18'	20'	22'	24'	26'	28'	30'	32'	34'	36'	38'	40'	42'	44'	46'	48'
Fixture Length	2'	1	1	1	1	1	1	1	1	1	1	1	1	1	1	1	1	1	1	1	1	1	1	1
Fixture Length	4'	1	1	1	1	1	1	1	1	1	1	1	1	1	1	1	1	1	1	1	1	1	1	1
Fixture Length	8'	1	1	1	1	1	1	2	2	2	2	3	3	3	3	4	4	4	4	5	5	5	5	6
Total Pendants Needed	2	2	3	2	3	3	4	3	4	4	5	4	5	5	6	5	6	6	7	6	7	7	8	7

LED SYSTEM DATA

Output	Delivered Lumens Per Foot	System Wattage Per Foot	CRI	LPW
Standard	506 Lm/Ft	3.3	82	148
High Standard	709 Lm/Ft	5.1	82	139
Medium	965 Lm/Ft	6.9	82	140
High Medium	1,468 Lm/Ft	10.3	82	143

Additional Lumen options available add desired lumens to end of part #
 e.g. LDL24SMSWL40MSMW43500

ENERGY AND PERFORMANCE DATA

Input Voltage	120/277 VAC
Standard Dimming Control	0-10V
CCT	3000, 3500, 4000, 5000 Kelvin
CRI	82 (minimum)
Life Time Rating	100,000 hrs at L70
Input Frequency	50/60Hz
Power Factor	>0.9
Operating Temp	Low Ambient -20°C/ High Ambient 50°C

Quick reference Output Guide Standard

Length	Lumens	Wattage
2 Foot	1012	6.6
3 Foot	1518	9.9
4 Foot	2024	13.2
6 Foot	3036	19.8
8 Foot	4048	26.4

Quick reference Output Guide Medium

Length	Lumens	Wattage
2 Foot	1418	10.2
3 Foot	2127	15.3
4 Foot	2836	20.4
6 Foot	4254	30.6
8 Foot	5672	40.8

Quick reference Output Guide High Standard

Length	Lumens	Wattage
2 Foot	1930	13.8
3 Foot	2895	20.7
4 Foot	3860	27.6
6 Foot	5790	41.4
8 Foot	7720	55.2

Quick reference Output Guide High Medium

Length	Lumens	Wattage
2 Foot	2936	20.6
3 Foot	4404	30.9
4 Foot	5872	41.2
6 Foot	8808	61.8
8 Foot	11744	82.4